

SITE PLAN FOR THE PROPOSED G+V STD. RESIDENTIAL FLAT BUILDING OF
1) ATANU GHOSH, 2) AGNIMITRA GHOSH, BOTH S/O- AMAL KUMAR
GHOSH, AT MAHALLA- KANAINATSAL NORTH, ON MOUZA- KANAINATSAL,
J.L.NO- 76, R.S. PLOT NO.- 111, R.S. KH.- NO- 76, L.R.PLOT NO-111/724,
L.R.KH.NO-13,7, HOLDING NO- 25, WARD NO.- 12, UNDER BURDWAN
MUNICIPALITY, P.S. & DIST. - BURDWAN.

LATITUDE : 23.221790N
LONGITUDE : 87.880089E

AREA OF LAND:- 4211.17 SQ.FT.

NATURE OF LAND:- BASTU

OWNER LAND SHOWN IN COLOUR -

EXIST. CONST. SHOWN IN COLOUR -

DRAIN SHOWN IN COLOUR -

EXIST. ROAD SHOWN IN COLOUR -

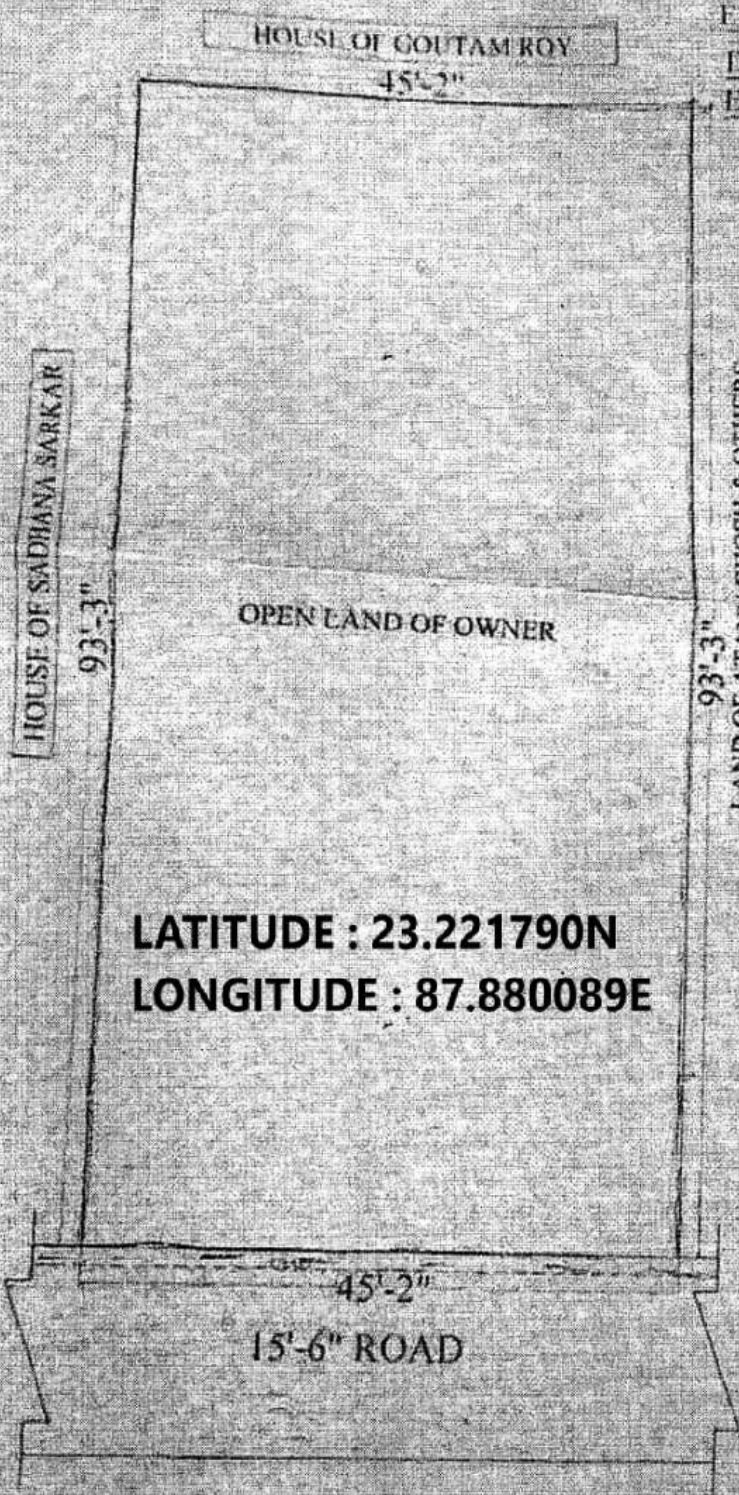

LATITUDE : 23.221790N
LONGITUDE : 87.880089E

SITE PLAN
SCALE-1"=16'-0"

G.M. Shukla
 12-12-18
Vice-Chairman
 Burdwan Municipality

VICE-CHAIRMAN

G. Ghosh
ENGINEER

M. Ghosh
HEALTH OFFICER

S. Ghosh *S. Ghosh*

DRAWN BY

Atanu Ghosh
Agnimitra Ghosh